

FICHA DE META DADOS – CEDIM 2019/1	
Nome da Pasta	Arquivo de Plantas da Prefeitura da Cidade de Nova Iguaçu
Autor/Instituição	Secretaria Municipal de Infraestrutura- SEMIF/ Subsecretaria de Urbanismo de Nova Iguaçu.
Número de Documentos	1
Quantidade e tipo de documentação	Uma planta de modificação de loteamento
Dia/ Mês/Ano	***
Série	127/50
Formato	***
Resumo	O acervo contempla tanto plantas residenciais e comerciais, quanto plantas de loteamento na cidade de Nova Iguaçu na primeira metade do século XX. Depositadas junto a Secretaria Municipal de Infraestrutura-SEMIF/Subsecretaria de Urbanismo de Nova Iguaçu, a documentação possui dados como nome do proprietário, logradouro, dimensões do terreno e profissional responsável pela obra. Dentre as plantas já digitalizadas, está o prédio da câmara Municipal, edificada em 1907 sendo posteriormente ocupado pela Prefeitura Municipal até sua demolição em 1964. Loteamento de bairros inteiros como Austin, Vila Anita e Caiçara. A maior parte da documentação



MINISTÉRIO DA EDUCAÇÃO
UNIVERSIDADE FEDERAL RURAL DO RIO DE JANEIRO
INSTITUTO MULTIDISCIPLINAR – CAMPUS NOVA IGUAÇU
CENTRO DE DOCUMENTAÇÃO E IMAGEM



	encontra-se em bom estado, mas também pode conter marcas de dobraduras e desgaste pelo manuseio contínuo.
Palavras-Chave	Planta; Nova Iguaçu; Cidade Jardim Cabuçu; Empresa Granja Paraíso S.A.; Fazenda Cabuçu;
Notas explicativas	O documento se encontra em baixo estado de conservação

11



O PROPRIETARIO:

[Handwritten signature]
Superintendente

AUTOR DO PROJETO
E
RESP. P/EXEC. DA OBRA



OBJETO
OBRA

Jose Rebelo
JOSE REBELLO DE
Eng. Civil - CRE

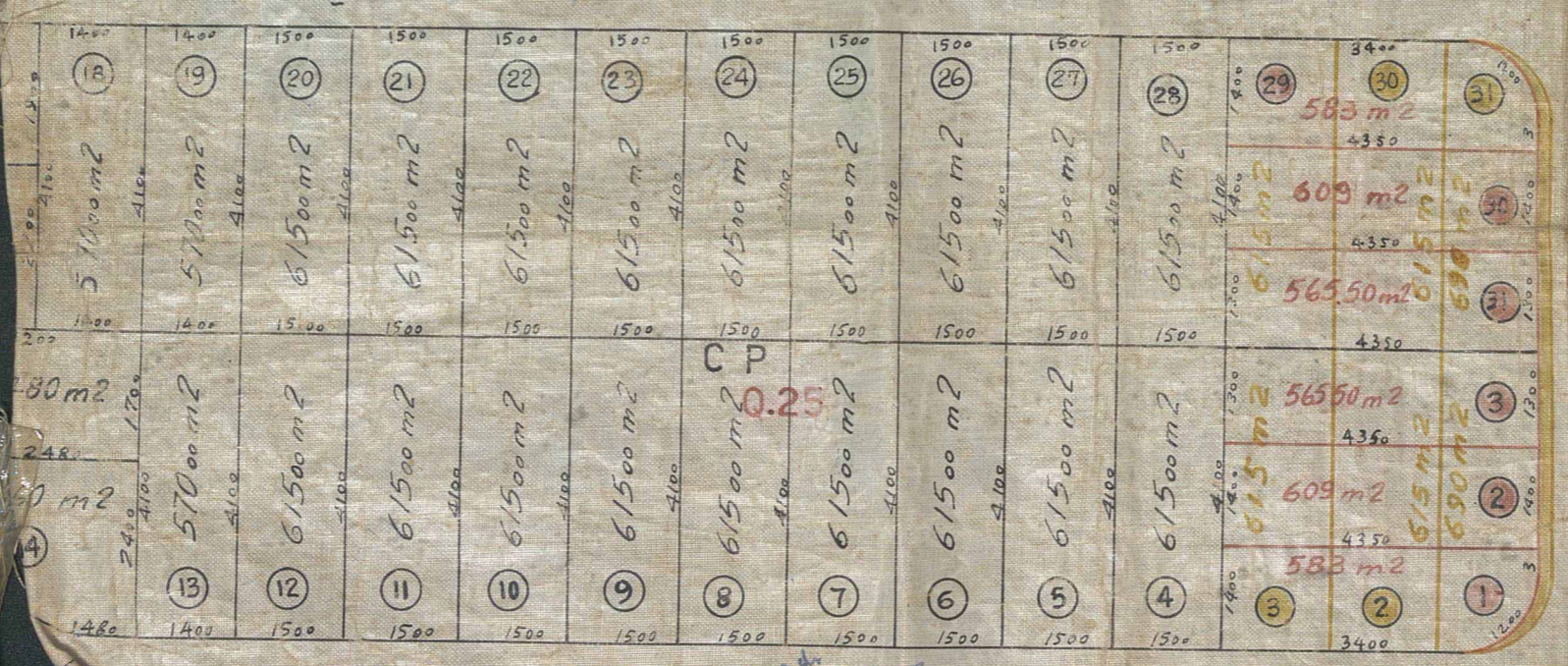
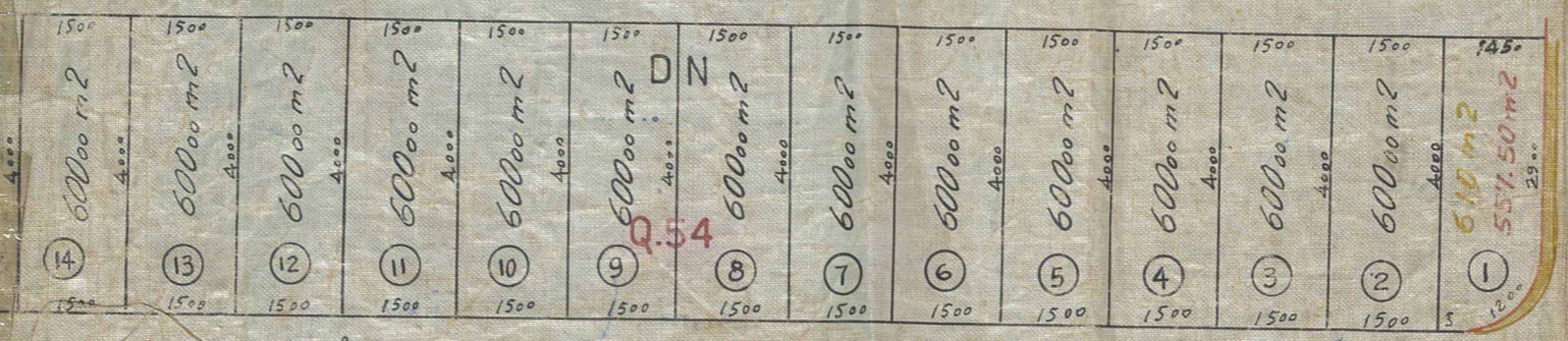
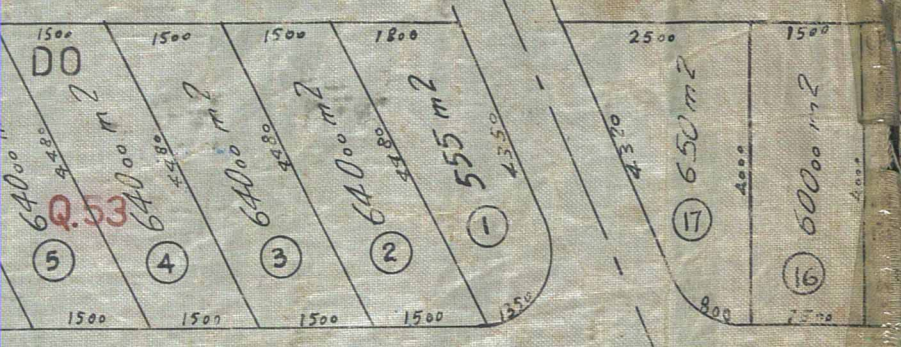

EMPRESA GRANJA PARAISO S.A.

TERRENOS DA FAZENDA CABUCU

MUNICIPIO DE N. IGUAQU

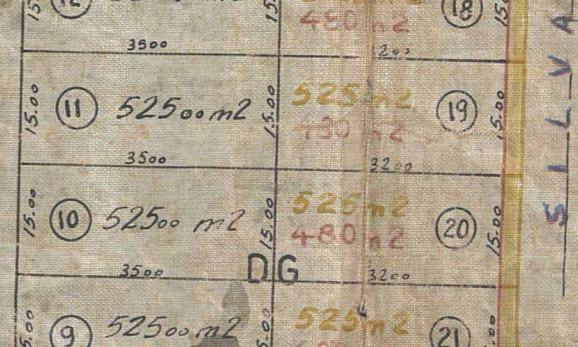
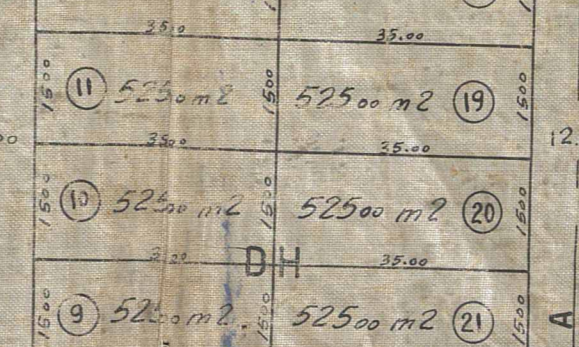
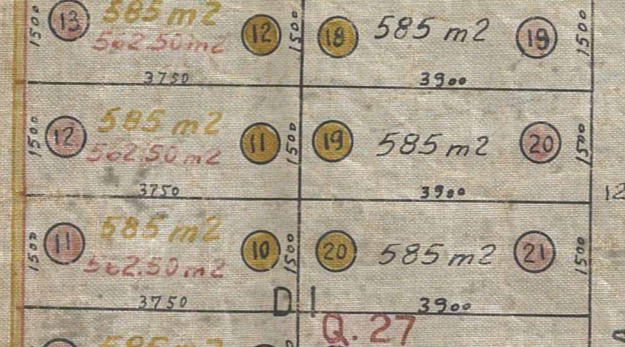
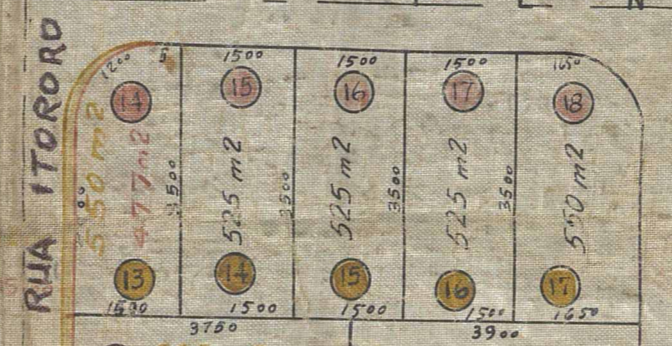
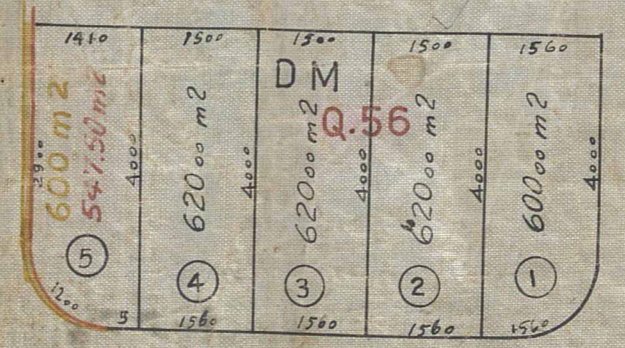

EMPRESA GRANJA PARAISO S.A.

PROJETO DE MODIFICAÇÃO DO LOTEAMENTO

TERRENOS DA FAZENDA CABUCU

Z1 - CIDADE JARDIM-CABUCU

MUNICIPIO DE N. IGUAÇU

ESCALA: 1:1.000

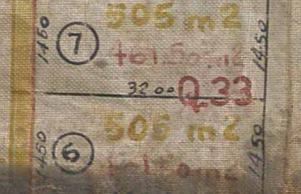
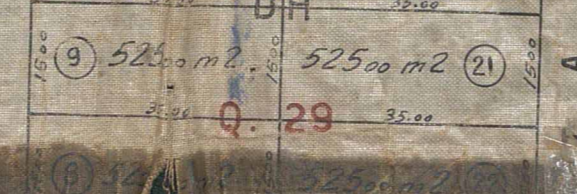
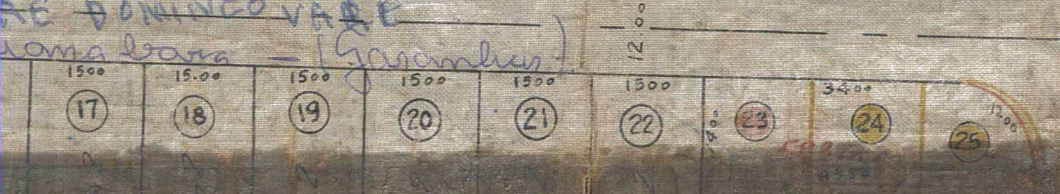
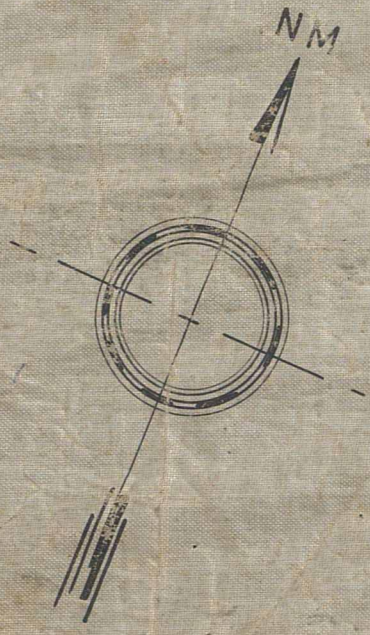
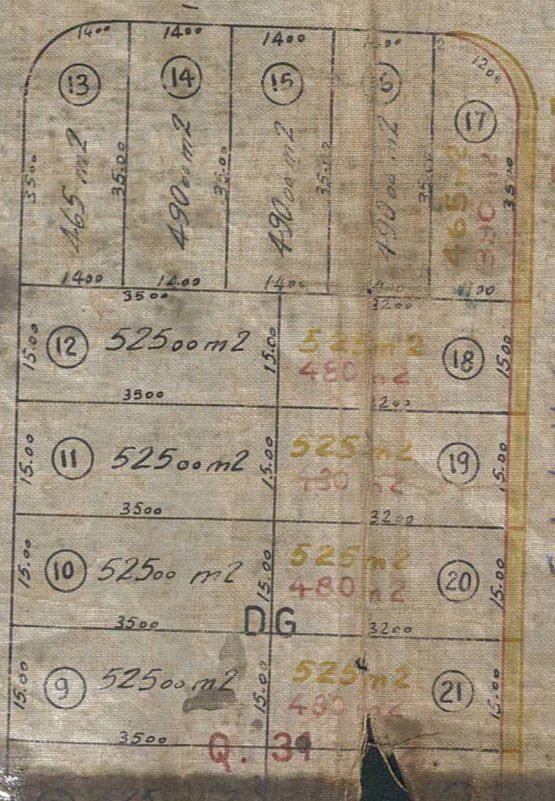
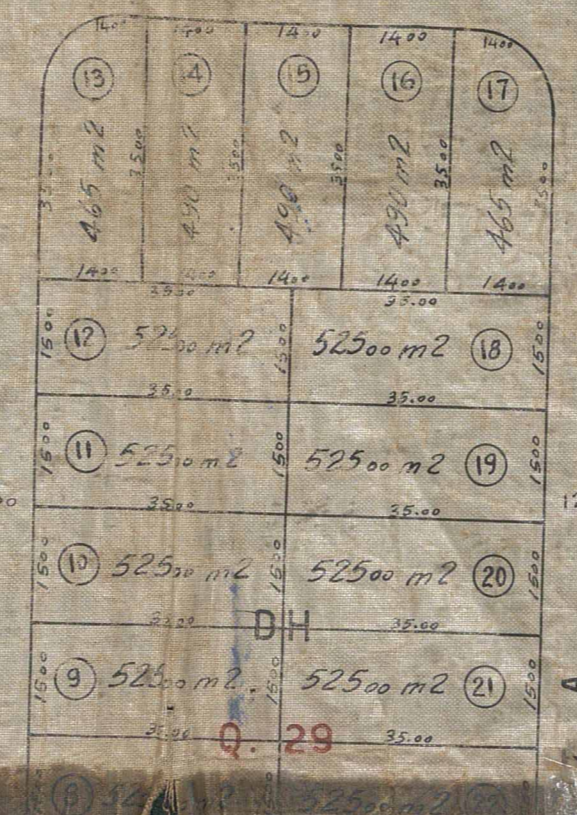
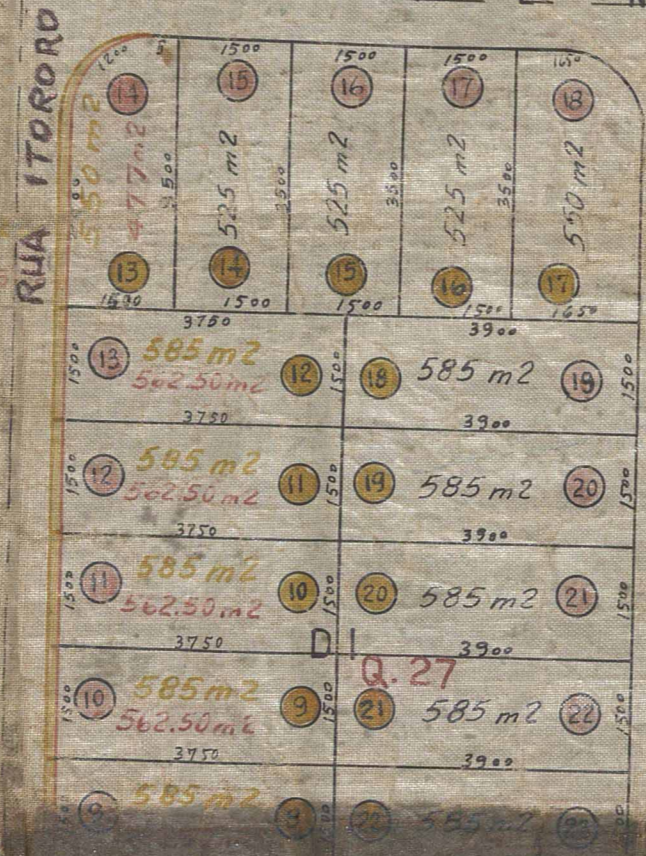
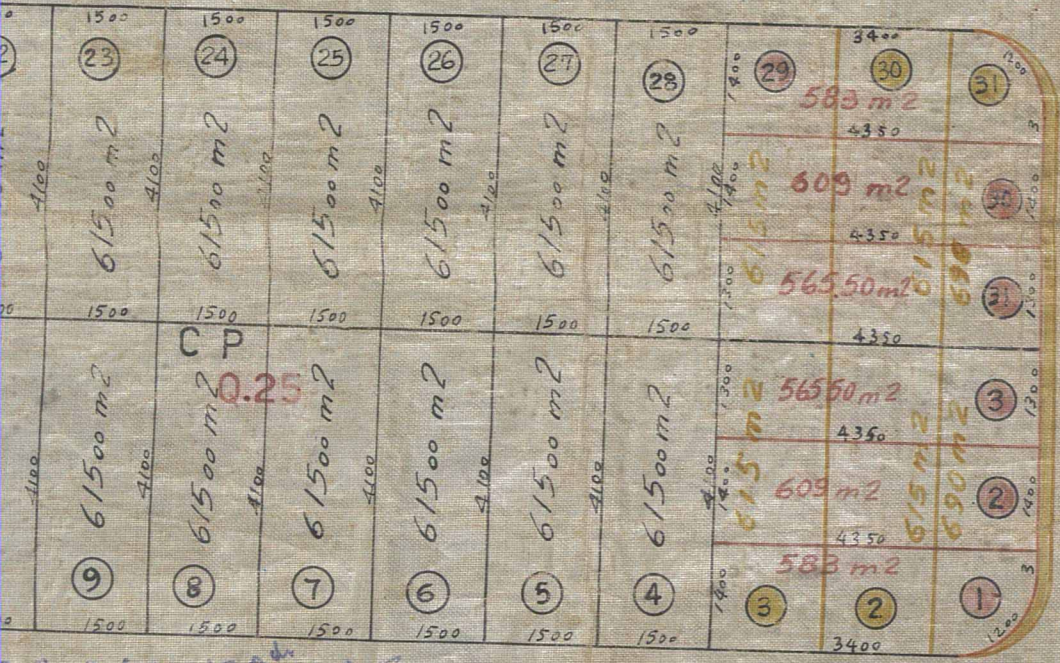
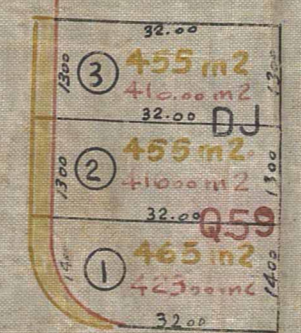
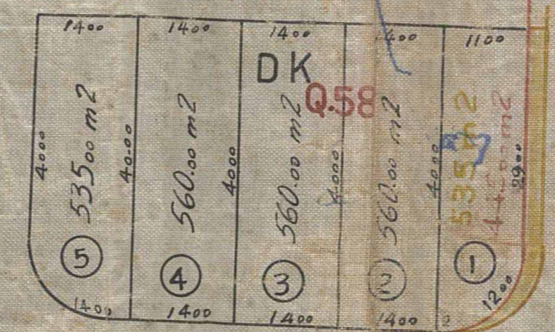
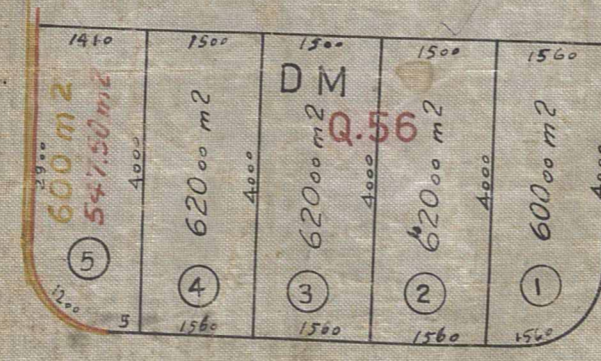
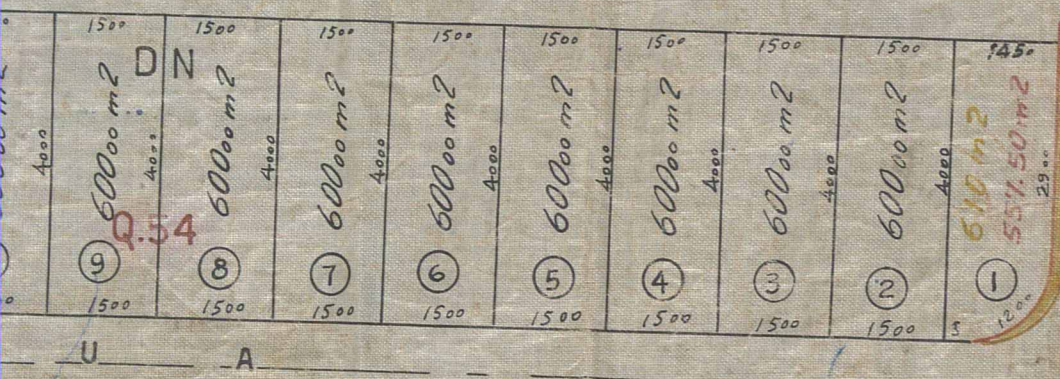

Q.49

P.M.N.I.

10.700 m²

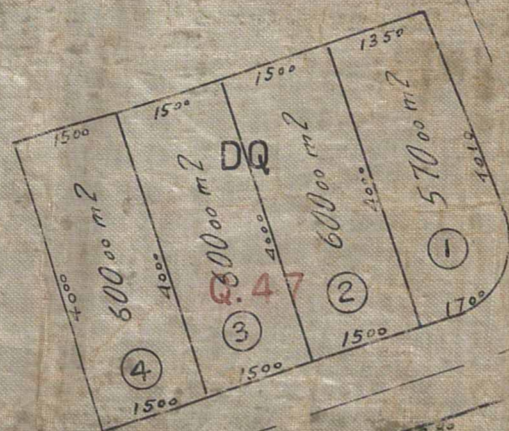

PRAÇA MARIA CRISTINA
8.400 m²

P.M.N.I.
10.700 m²

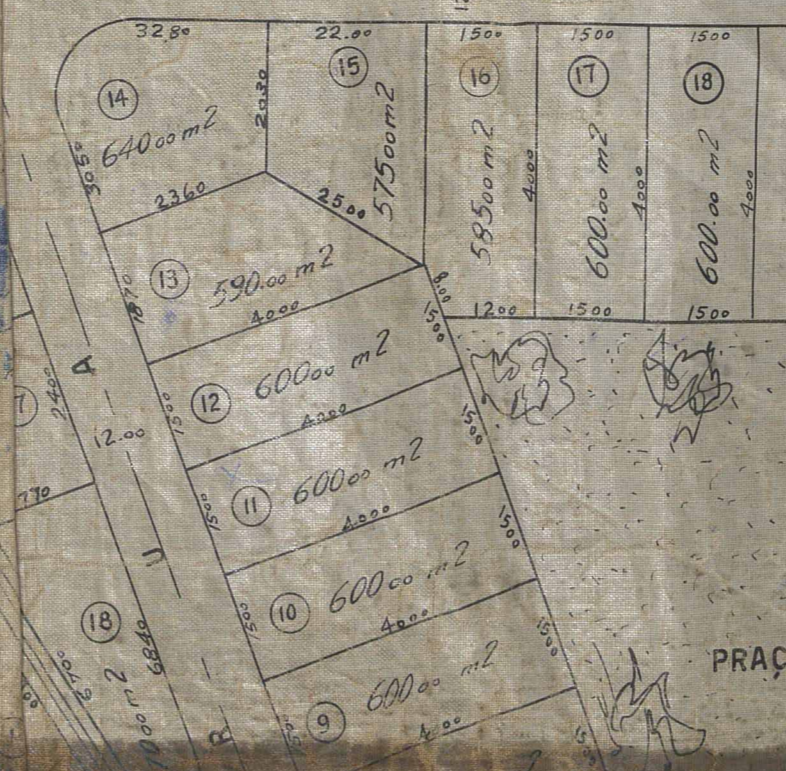
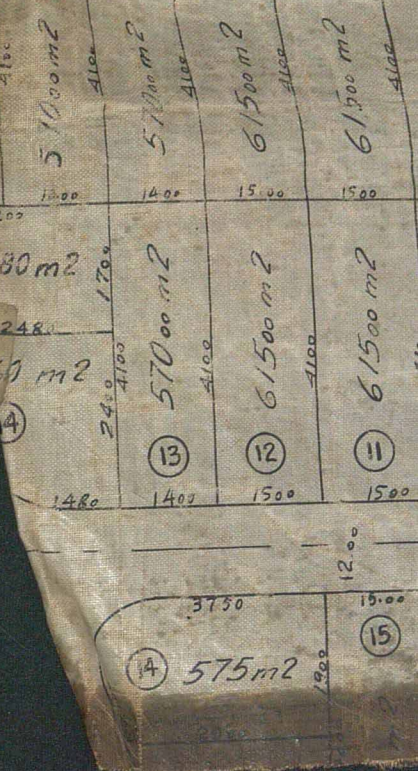
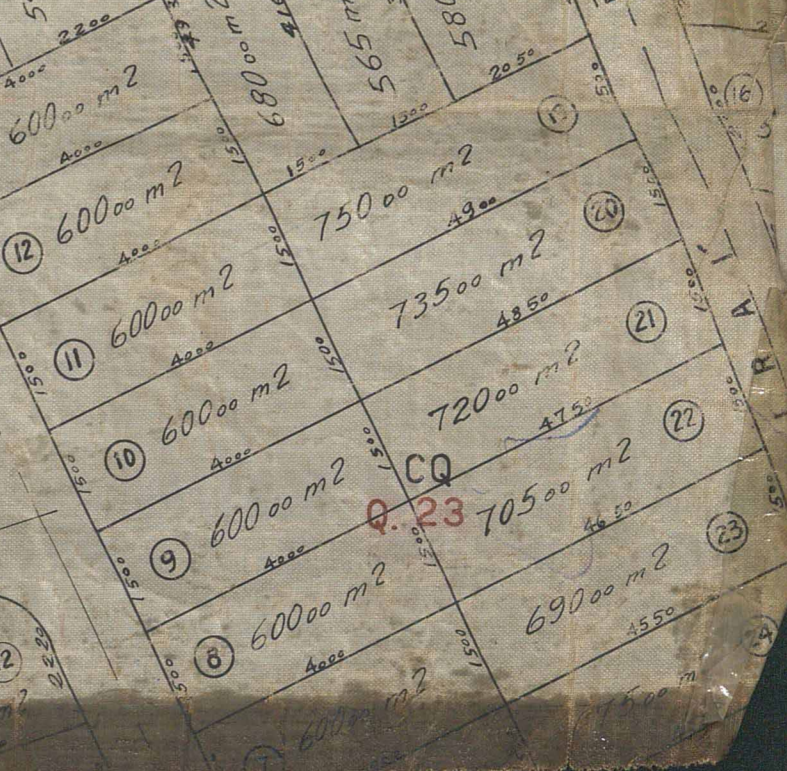
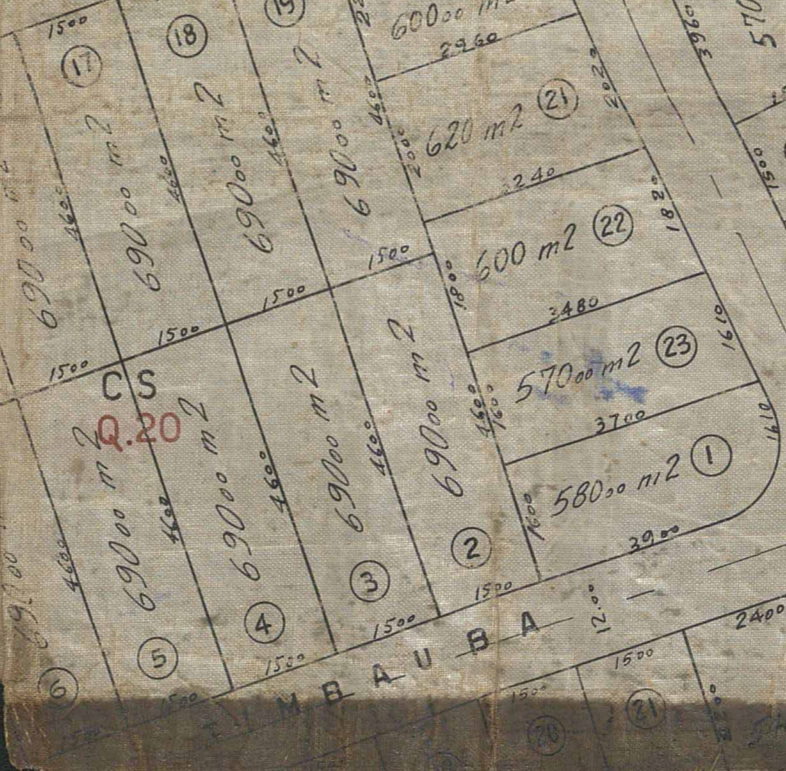
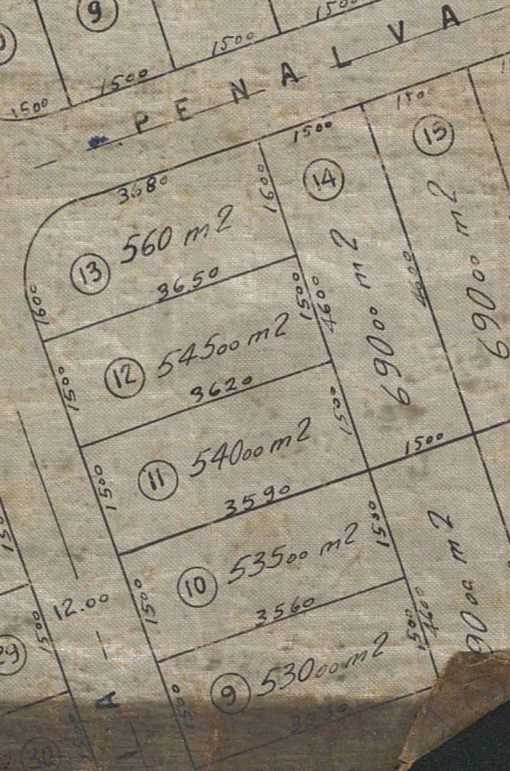
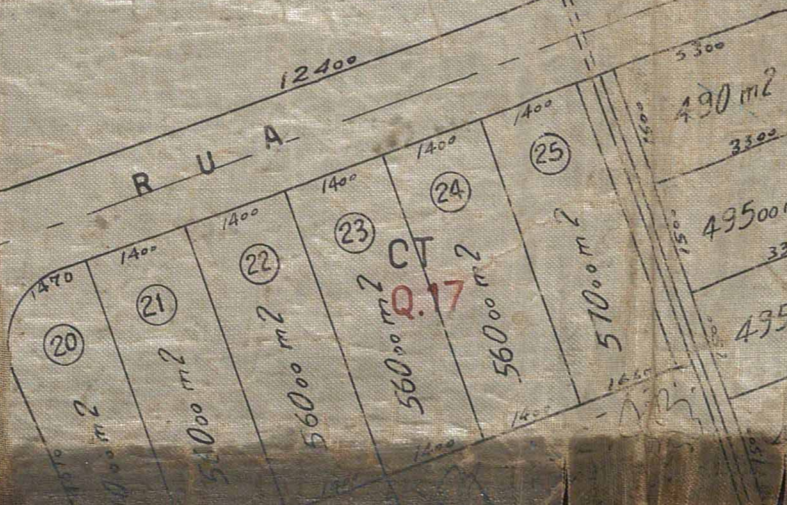
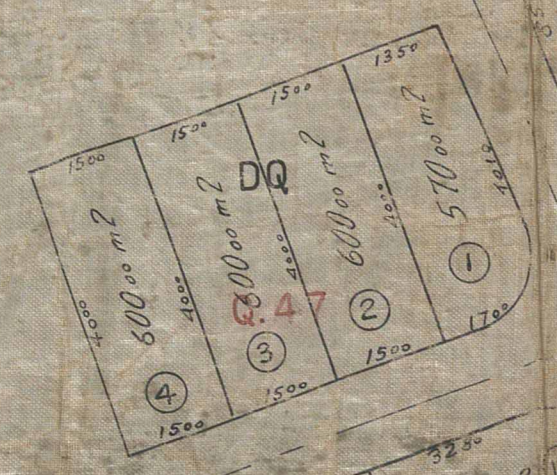

PRACA MARIA CRISTINA
8.400 m²

ESTRADA

ACERVO DIGITALIZADO



CEDIM
CENTRO DE DOCUMENTAÇÃO E IMAGEM
INSTITUTO MULTIDISCIPLINAR - UFRRJ



ARQUIVO DE PLANTAS